

OPTIONAL GLAMOUR  
OWNER'S BATH

OPTIONAL COVERED PORCH

1989 Plan

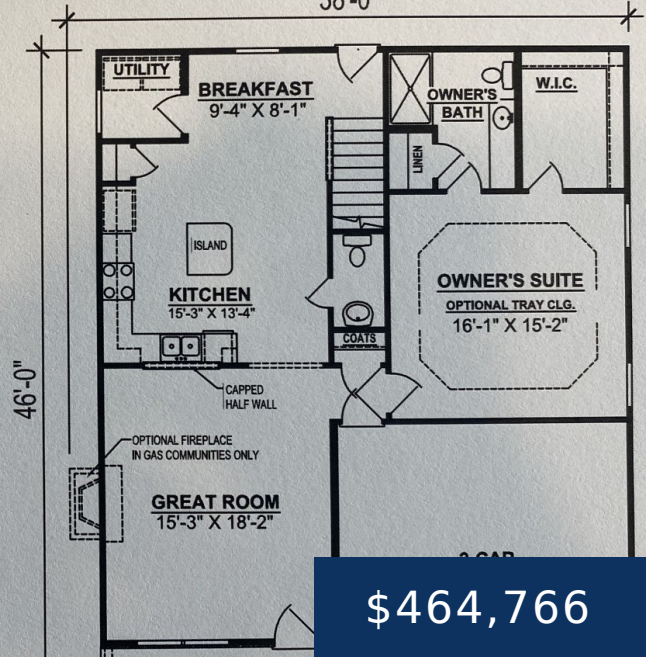
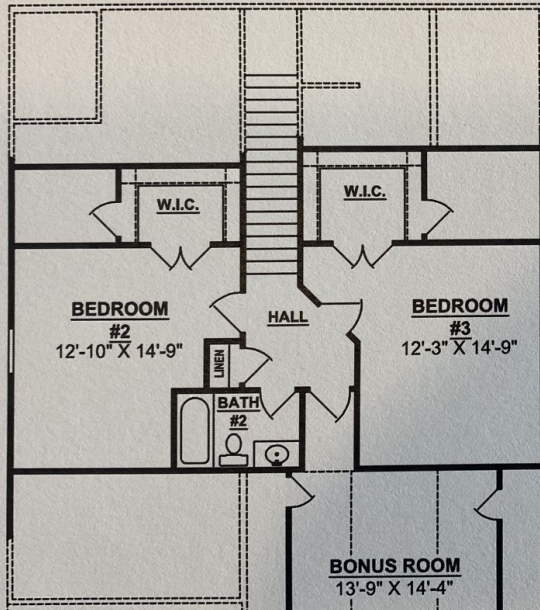

\$464,766

**3918 EASTWIND DRIVE, ROCKVALE, TN, US,  
37153**

<https://thecottagerealty.com>

Plan (1989 Elevation DEF) This beautiful home has Laminate flooring on great rm, kitchen, dining area, and powder rm. Quartz kitchen countertops, staggered height cabinets with crown molding, tile kitchen backsplash, and under cabinet lighting. LARGE walk in closets in all 3 bedrooms. Primary Bathroom features 5 ft. Tiled Shower. Limited Time Special- \$99 Contract [...]

- 3 beds
- 2 baths
- Residential
- Single Family Residence
- Active
- 2002 sq ft

## Rooms



Room type	Dimensions
Bedroom 1	16x15
Bedroom 2	14x12
Bedroom 3	14x12
Bonus Room	14x13
Dining Room	9x8
Kitchen	15x13
Living Room	18x15

## Building Details

- ParkingTotal:

2
- Heating:

Heat Pump, Natural Gas
- Exterior material:

Fiber Cement, Stone
- NewConstructionYN:

Yes
- Basement:

Slab
- Parking:

Attached - Front

## Amenities & Features

- Waterfront available:

No
- AttachedGarageYN:

Yes
- PoolPrivateYN:

No
- ExteriorFeatures:

Garage Door Opener
- Amenities:

Dishwasher, Disposal, Ice Maker, Microwave, Refrigerator
- GarageYN:

Yes
- FireplaceYN:

No
- Cooling:

Central Air
- Utilities:

Water Available
- Features:

Ceiling Fan(s), Primary Bedroom Main Floor

